

# AXIS 360

COMMERCIAL REAL ESTATE

3001½ Gill St.  
Suite A  
Bloomington, Illinois

[www.axis360.co](http://www.axis360.co)



## FOR LEASE - Office Space

### ADDRESS

2703 McGraw, Suite 5  
Bloomington, Illinois

### SIZE

100 & 150 sq. ft.

### LEASE RATE

\$400 & \$450/month

### LEASE TYPE

Modified Gross (prorated  
share of gas and electric)

### LEASE TERM

2 year minimum

### Zoning

B-1

### PROPERTY OVERVIEW

- Terrific location along Veteran's Parkway
- Located between State Farm Corporate and Corporate South
- Plenty of parking (approx. 9:1000)
- Close to shopping and dining
- Owner Occupied building

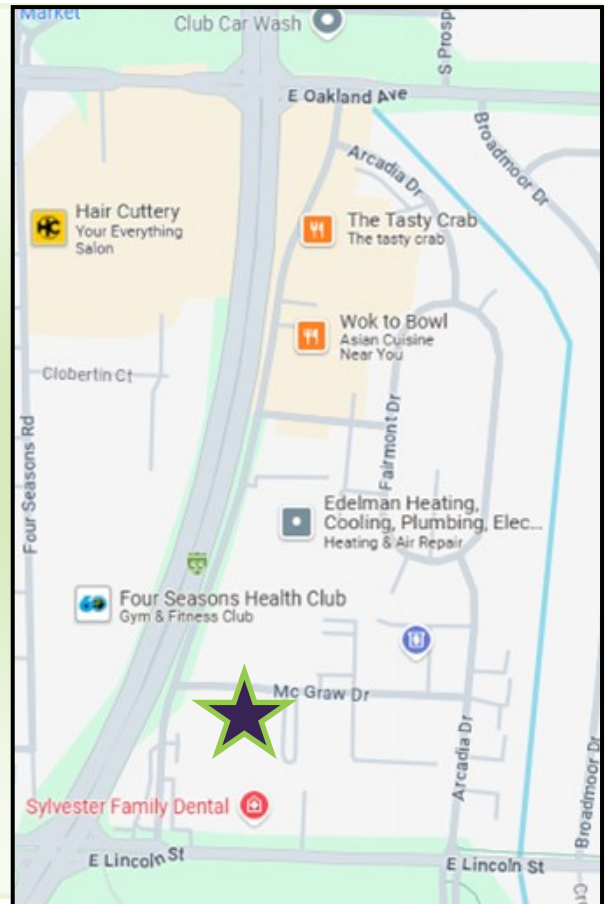

**Laura Pritts**  
Designated Managing Broker  
[lpritts@axis360.co](mailto:lpritts@axis360.co)  
(309) 824-0507

Visit our Website:  
[www.axis360.co](http://www.axis360.co)



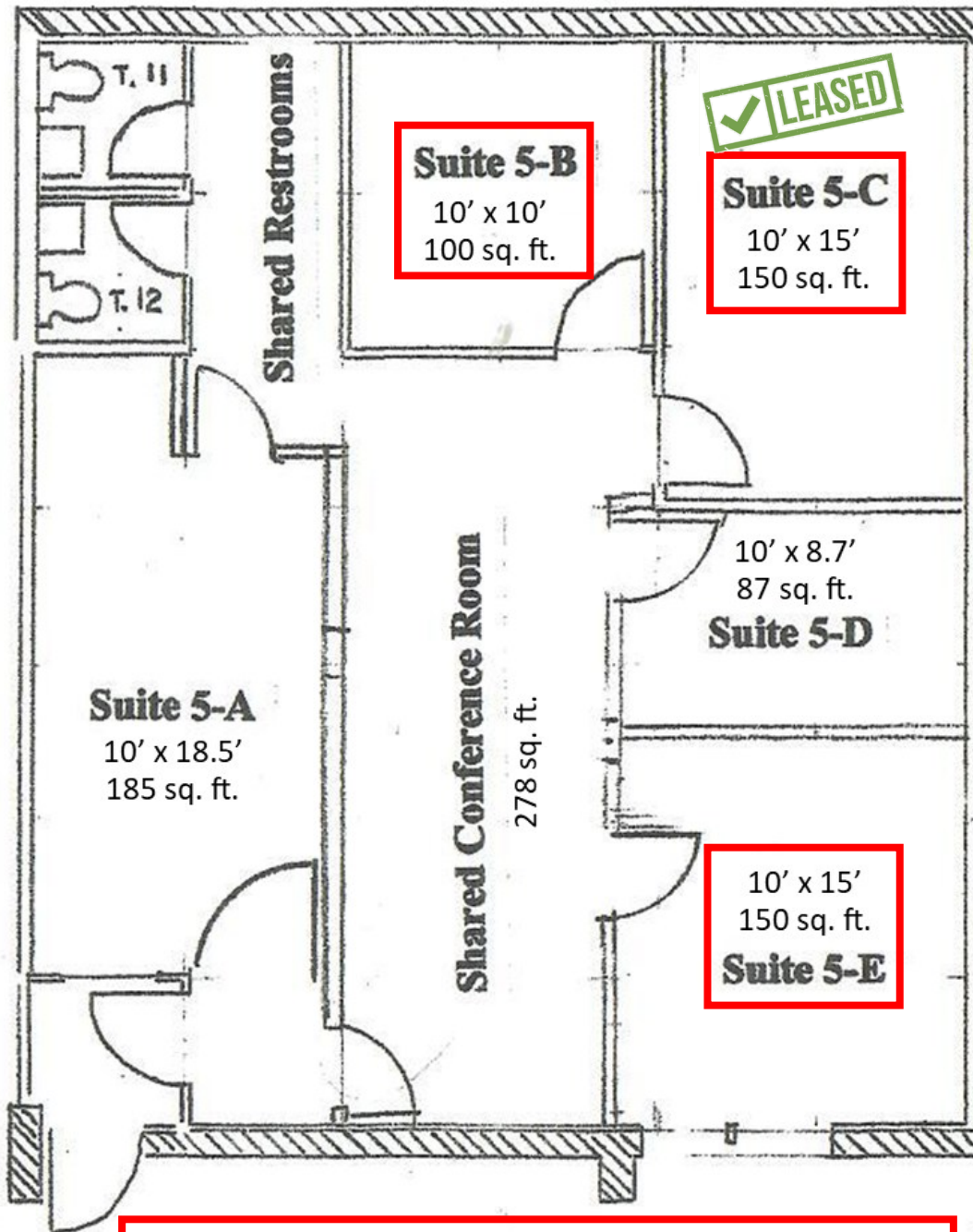

### Suite #5

Suite B — \$400/month + prorated share of gas/electric  
Suite C — \$400/month + prorated share of gas/electric  
Suite E — \$450/month + prorated share of gas/electric